

isocheck™

Screedcheck XL8 System

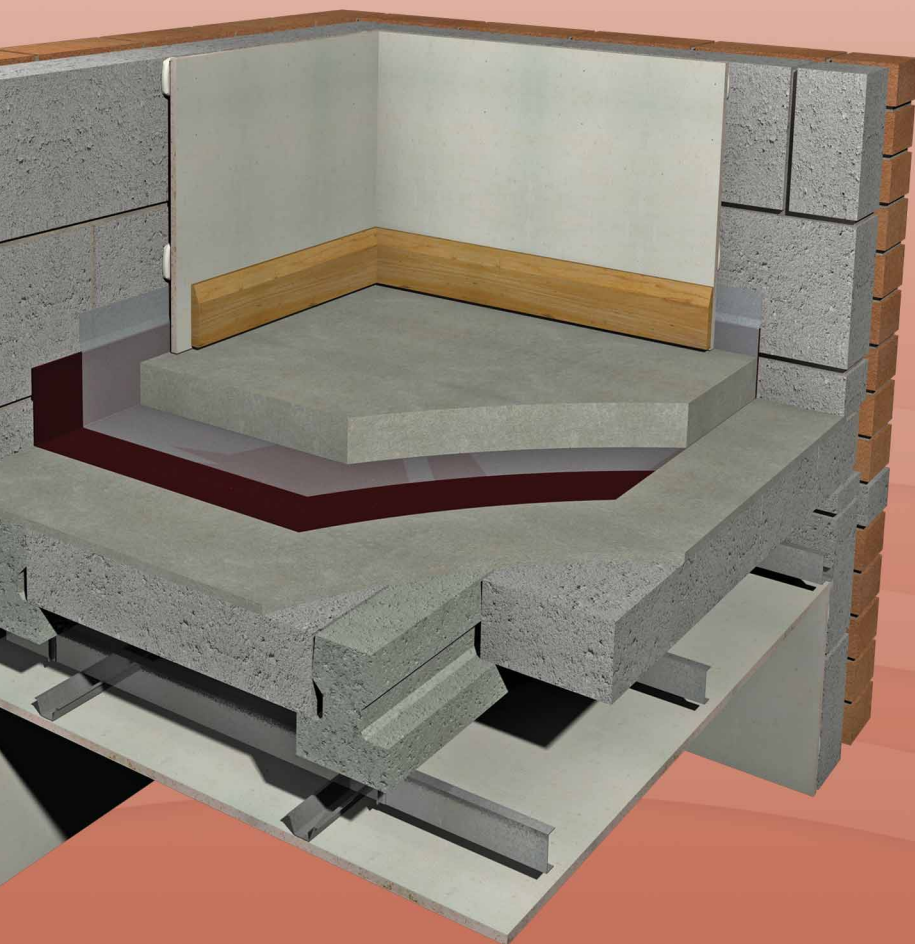

IMPACT IMPROVEMENT SYSTEM FOR BEAM & BLOCK FLOORS

- New build
- Conversions



DESCRIPTION

- ❑ The isocheck screedcheck XL8 system from Isomass features a 8mm closed cell cross linked foam layer that has been designed to be placed within a masonry structural floor directly below the screed. This isolates the screed from the structural sub floor, and provides sufficient impact absorption to place it amongst the top performing systems available.
- ❑ By ensuring that all the joints are taped, bridging will be eliminated which is the single greatest cause of failure of any system of this type.
- ❑ When installed correctly, the XL8 system will enable compliance with Approved Document E 2003 and subsequent amendments in 2004, 2010, 2013 & 2015.

BENEFITS

- ❑ Closed cells prevents water absorption which can impair acoustic performance.
- ❑ All installations over 500m² come with a free site pre screed inspection.



We take the *mystery* out of Acoustics

Product data

Roll dimensions:	1.85m wide x 60m
Thickness:	8mm
Foam composition:	Closed Cell Cross Linked Isopoli

Performance (on the construction below)

Treated floor with:	$D_{nT,w} + C_{tr}$	$L'_{nT,w}$
screedcheck XL8	50dB	≤45dB

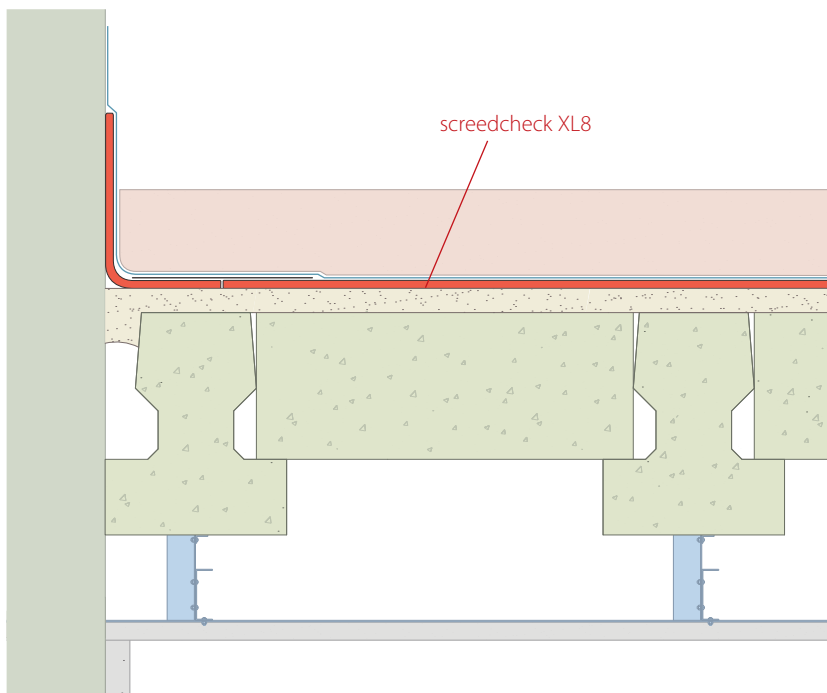

- ❑ 80kg/m² sand/cement screed or 65mm proprietary screed.
- ❑ Optional plastic sheeting - to aid screed pouring and maintain joints in screedcheck XL8.
- ❑ Screedcheck XL8 on grouted sub floor.
- ❑ ≥300kg/m² minimum structural beam and block floor with optional levelling screed.
- ❑ 75mm min. void formed by metal frame suspended ceiling system and ≥10kg/m² gypsum board ceiling.

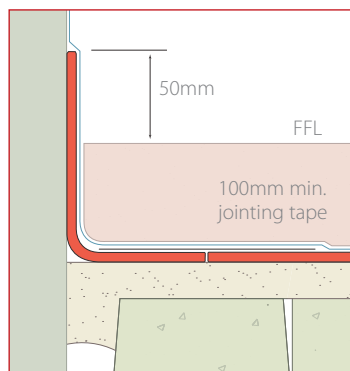

SPECIFICATION

The acoustic floor shall be:

- ❑ Isocheck Screedcheck XL8, manufactured by Isomass Ltd. Units 10 & 11, Avenue Business Park, Off Brockley Road, Elsworth, Cambridgeshire, CB23 4EY and installed in accordance with manufacturer's instructions / recommendations.

INSTALLATION

- ❑ The floor surface should be swept free of any loose debris that may damage or bridge the system.
- ❑ A separate piece of screedcheck XL8 should be used as a perimeter flanking strip. This piece should be butt-jointed and taped to the main layer and include a minimum 50mm to protrude above the intended FFL of the screed (left).
- ❑ Adjoining roll edges should be butt-jointed and sealed with a minimum 100mm wide jointing tape.
- ❑ Services that penetrate the screed should be isolated by wrapping with screedcheck XL8 which again would be taped.
- ❑ When trafficking the floor take care not to perform any unnecessary actions that may cause any of the taped joints to be forced apart.

Every effort has been taken in the preparation of this sheet to ensure the accuracy of representations contained herein. Recommendations as to the use of materials, construction details and methods of installation are given in good faith and relate to typical situations. However, every site has different characteristics and reliance should not be placed upon the foregoing recommendations. Advice can be given as to specific applications of the products, upon request to isomass building products.